



RIV 3301

Male bayonet fastening

Tech drawings and tables

DN	Code	Ø	H	F	PN	KG	P/box
1/2"	033301000004	15	32	10	16	0,089	10
3/4"	033301000005	20	32	10	16	0,094	10
1"	033301000007	24	32	10	16	0,093	10
1"1/4	033301000008	24	41	17	16	0,136	10
1"1/2	033301000009	24	41	17	16	0,163	10

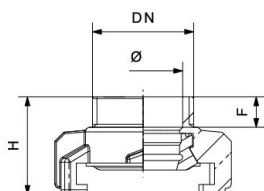

Advantages

The "SWIFT" bayonet fastenings feature the same bayonet coupling for all sizes.

Therefore couplings of different dimensions, with hose-connections or threaded ones, from 1/2" to 1 1/2" (see drawings) can be joined very simply and safely, composing the required connection or reduction according to needs.

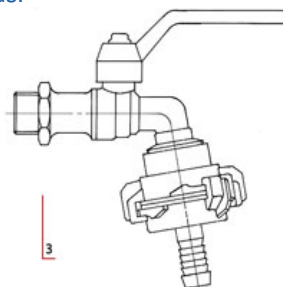
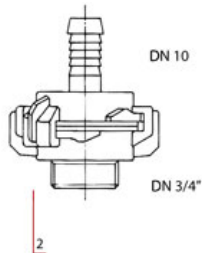
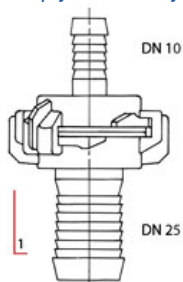

Technical data

Art. 3300

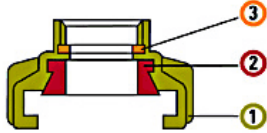

Materials

1	Body	Brass CW617N
2	Gasket	NBR
3	Gasket	NBR

Connections

ISO 228/1

Limit

-10°C (without liquid) +90°C

Notes

The max. working pressure (PN) means at a room temperature of about 23°C.